

Corporate Chefs

est. 1987

Meals at work should be a break from work. We are serving up great food, service and smiles to make every workday a better day. That is the goal of our Corporate Chefs team for all of the services we provide.



**READY TO
DOWNLOAD YOUR
NEW DINING APP?**



1

DOWNLOAD THE APP

It's simple to browse today's menu, order your next meal in advance or add a declining balance.

2

CREATE YOUR ACCOUNT

Follow instructions to register for the 365Pay App. **Sub-steps detailed on following pages.**

3

LOCATION CODE: 157873

From the shop button, select Link Location button and enter this code to order from your Local Cafe.

4

INPUT YOUR ORDER

Select your pick-up time, add food and beverages to your cart, input your payment and checkout.

Corporate *est. 1987* Chefs

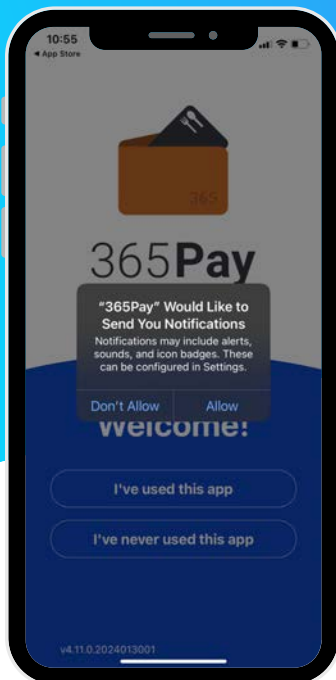

Step 1:
Download and
open the app.

Please allow
Notifications.

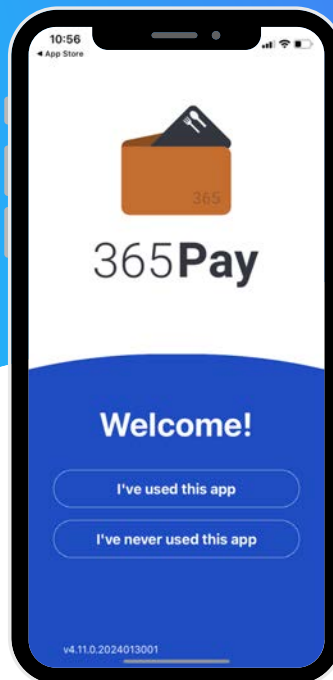

Step 2:
Select 'I've
never used
this app'.

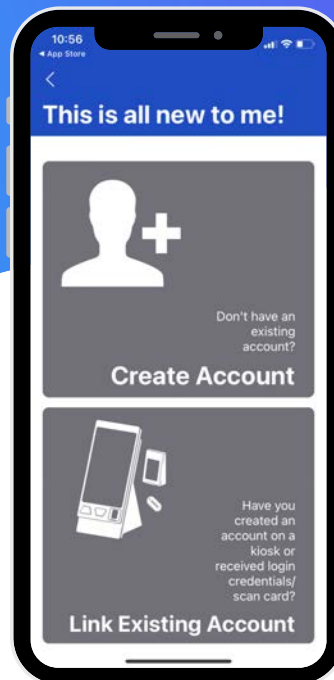

Step 3:
Create
Account.

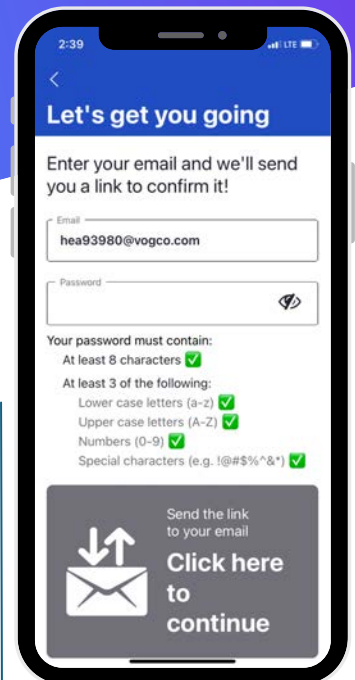

Step 4:
Enter your
email and a
password.

Select 'Click
here to
continue'.

Corporate *est. 1987* Chefs

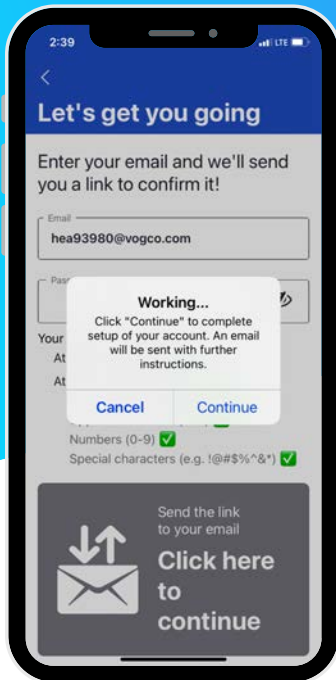

Step 5:
Click
continue.

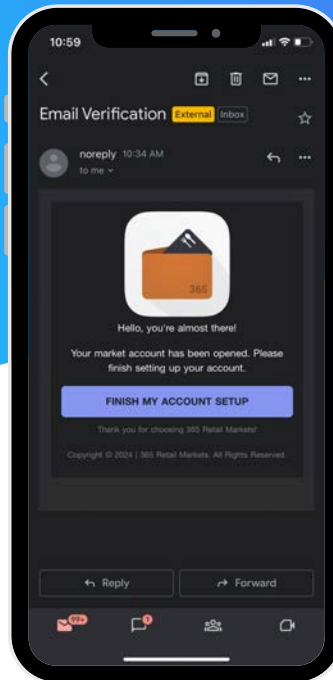

Step 6:
Navigate to
your Email
Verification.

Click 'Finish
My Account
Setup'.

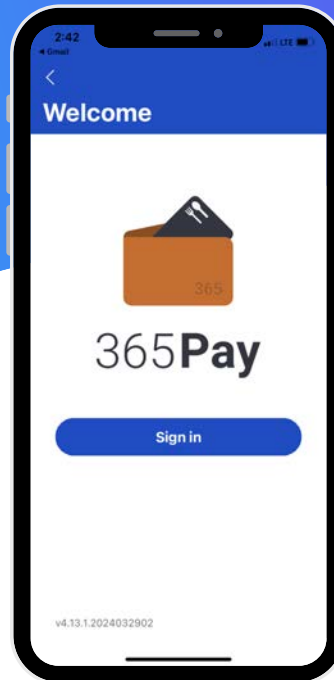

Step 7:
It should take
you back to
the app sign
in screen.

Click 'Sign
In'.

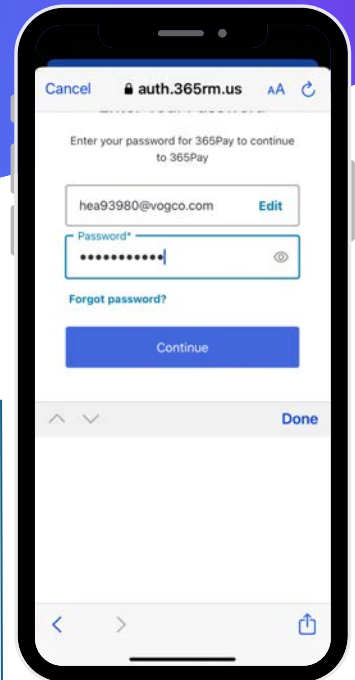

Step 8:
Enter your
Email and the
password you
just created.

Corporate *est. 1987* Chefs

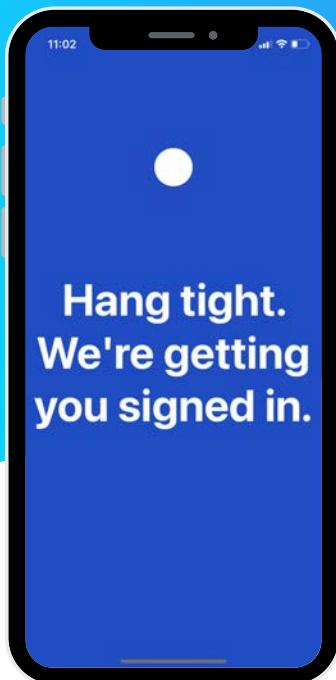

Step 9:
Click
Continue and
you'll be
signed in and
prompted to
enter some
information.

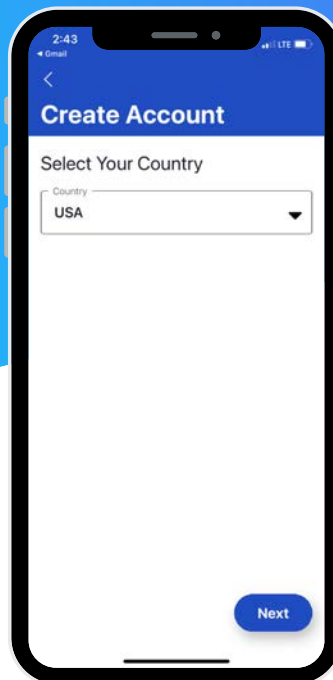

Step 10:
Select next.

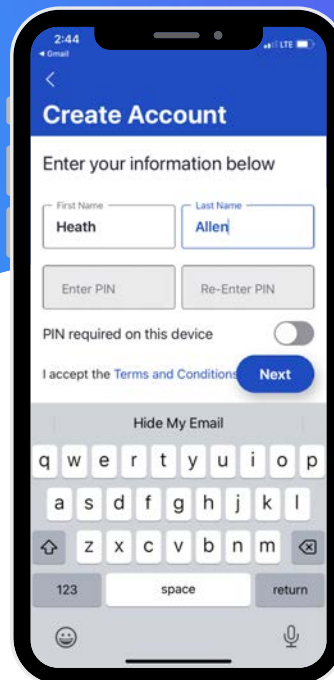

Step 11:
Enter your
First and Last
Name.

Simply enter
and confirm
'1234' for the
PIN.

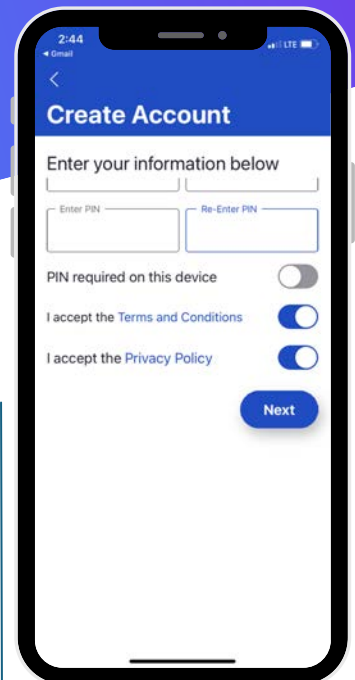

Step 12:
Toggle off Pin
required, but
toggle on
acceptance of
Terms and
Conditions
and Privacy
Policy.

Corporate *est. 1987* Chefs

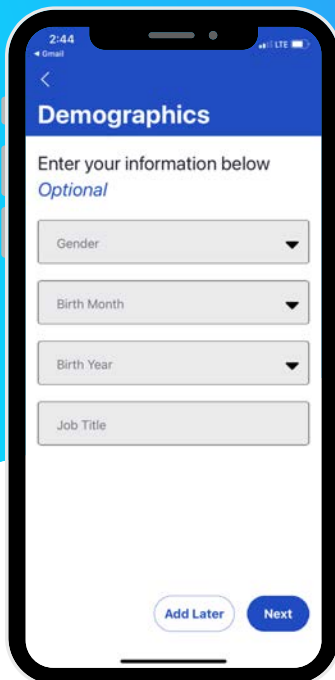

Demographics

Enter your information below
Optional

Gender

Birth Month

Birth Year

Job Title

Add Later Next

Step 13:
Select Add
Later for
Demographic
s.

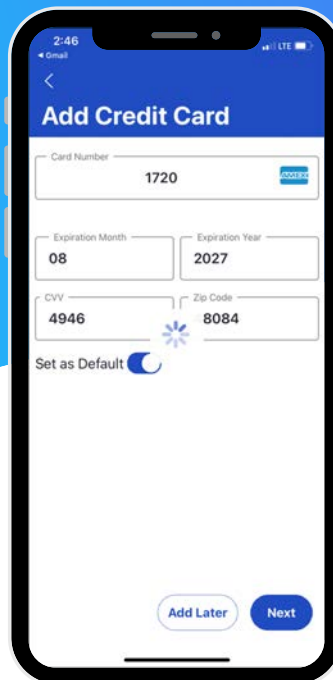

Add Credit Card

Card Number 1720

Expiration Month 08 Expiration Year 2027

CVV 4946 Zip Code 8084

Set as Default

Add Later Next

Step 14:
Add a credit
card to place
Orders for
pickup.

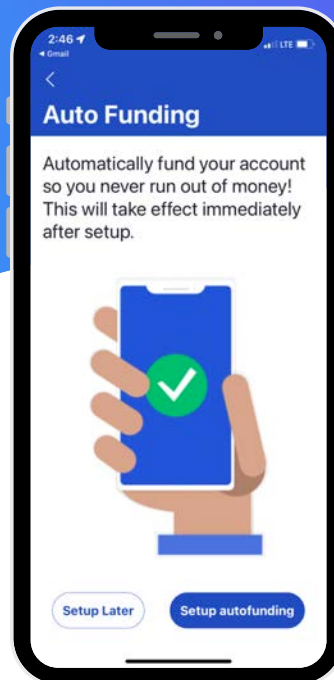

Auto Funding

Automatically fund your account
so you never run out of money!
This will take effect immediately
after setup.

Setup Later Setup autofunding

Step 15:
Select Setup
Later for
auto-funding.

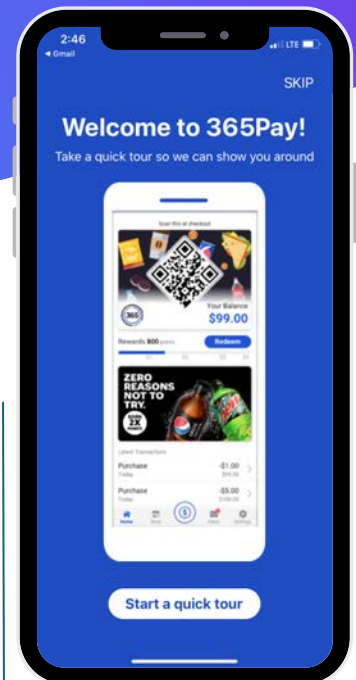

Welcome to 365Pay!

Take a quick tour so we can show you around

Start a quick tour

Step 16:
Hit Next and
your finished
with the
setup.

You can take
or Skip the
app tour to
learn more.